

Technisches Datenblatt Spiralgehäuse - Kreiselpumpen

Serie NM4 Grösse 65

Kennlinien bei	1450 ¹ /min.
Motor 4-polig	50 Hz
Wassertemperatur	20 °C

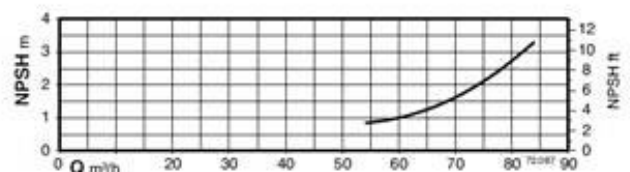
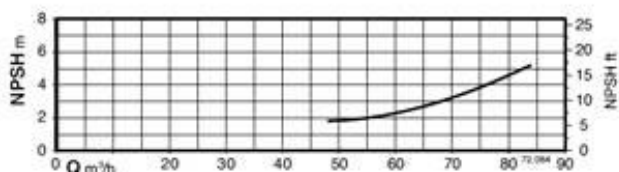
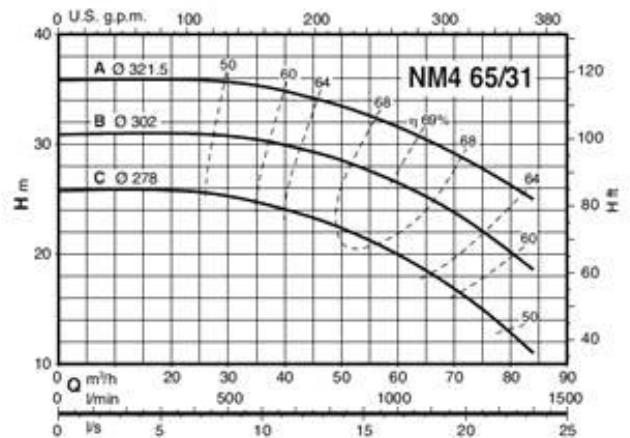
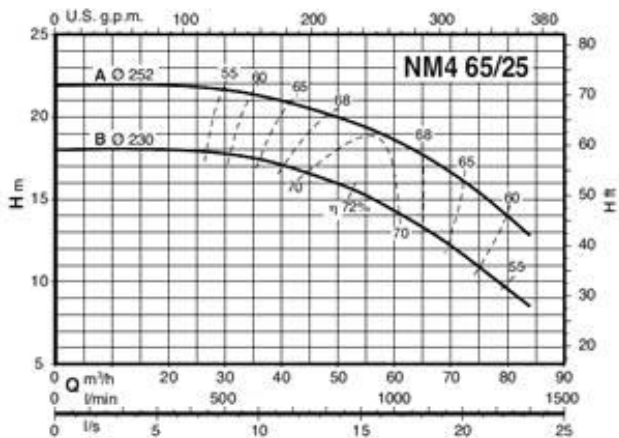
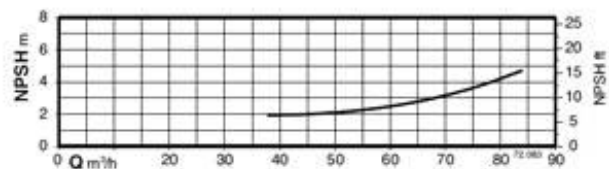
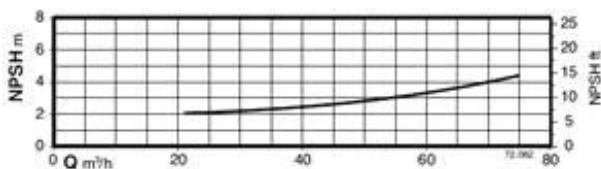
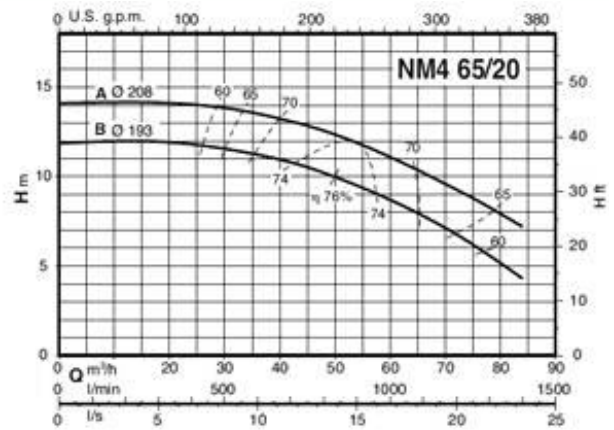
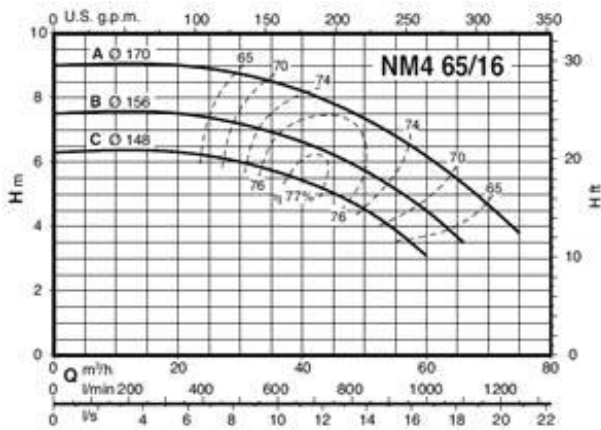

Massbild NM4 65

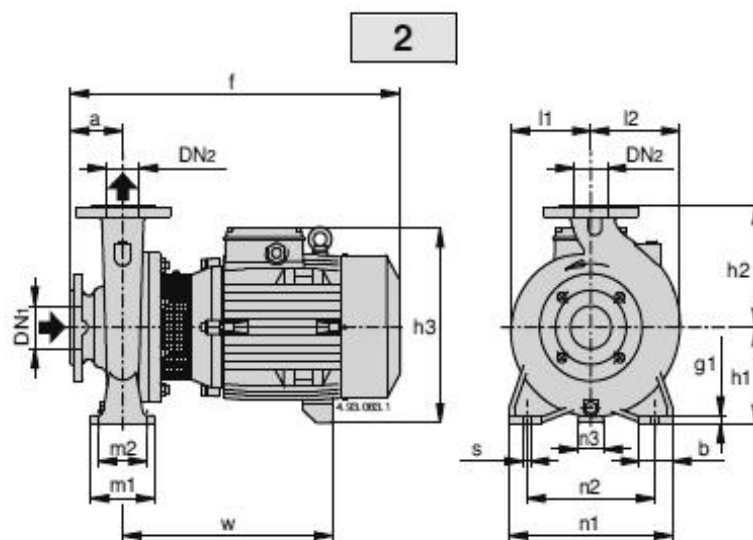

Pumpenmasse 4 - polig, 1450 ¹/min

Pumpentyp	Artikel-Nr.	Abmessungen in mm														Gewicht kg
		Bild	a	f	h1	h2	h3	m1	m2	n1	l1	l2	w	DN1	DN2	
NM4 65/16C/A	111.07739	2	100	470	160	200	288	125	95	280	150	172	255	80	65	48
NM4 65/16B/A	111.07740	2	100	470	160	200	288	125	95	280	150	172	255	80	65	48
NM4 65/16A/A	111.07741	2	100	495	160	200	288	125	95	280	150	172	300	80	65	54.5
NM4 65/20B/A	111.07742	2	100	505	180	225	308	125	95	320	155	175	310	80	65	61
NM4 65/20A/A	111.07743	2	100	525	180	225	340	125	95	320	155	175	330	80	65	73.5
NM4 65/25B/A	111.07744	2	100	540	200	250	360	160	120	360	175	190	345	80	65	97
NM4 65/25A/A	111.07745	2	100	645	200	250	385	160	120	360	175	190	415	80	65	116
NM4 65/31C/A	111.07746	2	125	670	225	280	410	160	120	400	220	220	455	80	65	153
NM4 65/31B/A	111.07747	2	125	670	225	280	410	160	120	400	220	220	455	80	65	164
NM4 65/31A/A	111.07748	2	125	720	225	280	410	160	120	400	220	220	465	80	65	176

Motordaten NM4 65, 4-polig, 1450 ¹/min

Pumpentyp	Leistung kW	Eingangsstrom in Ampere		
		3~230 V	3~400 V	3~690 V
NM4 65/16C/A	1.1	5	2.9	
NM4 65/16B/A	1.1	5	2.9	
NM4 65/16A/A	1.5	6	3.5	
NM4 65/20B/A	2.2	8.6	5	
NM4 65/20A/A	3	11.1	6.4	
NM4 65/25B/A	4		8.3	4.8
NM4 65/25A/A	5.5		12.5	7.2
NM4 65/31C/A	5.5		12.5	7.2
NM4 65/31B/A	7.5		16	9.2
NM4 65/31A/A	9.2		19	11



BRUNNER AG
 Brunnergässli 1
 CH-8302 Kloten
 Tel. 044 814 17 44
 Fax 044 814 17 75
 mail@brunnerpumpen.ch

BRUNNER AG
 Seefeldstrasse 1
 CH-8280 Kreuzlingen
 Tel. 079 654 01 48
 Fax 071 688 82 37
 www.brunnerpumpen.ch

BRUNNER SA
 Via in Paes 82
 CH-6572 Quartino
 Tel. 091 795 21 26
 Fax 091 795 28 92
 www.brunnerpompe.ch