

Technisches Datenblatt Spiralgehäuse - Kreiselpumpen

Serie NM4 Grösse 50

Kennlinien bei	1450 ¹ /min.
Motor 4-polig	50 Hz
Wassertemperatur	20 °C

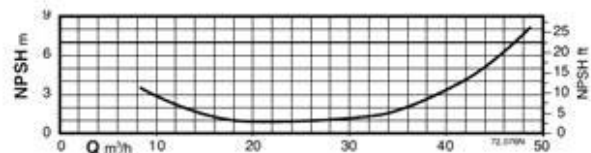
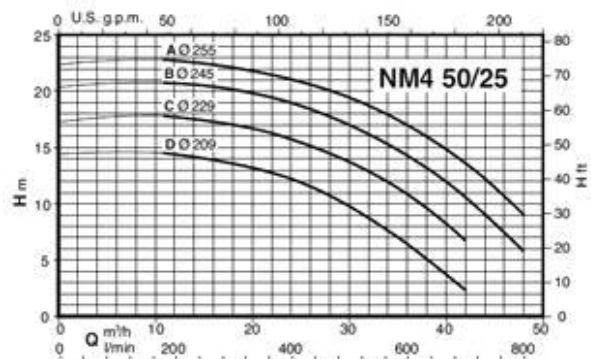
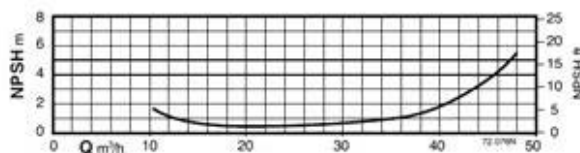
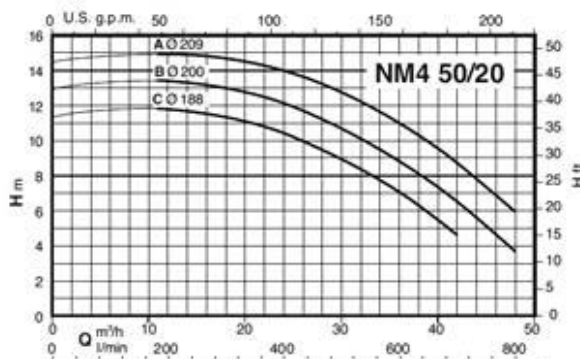
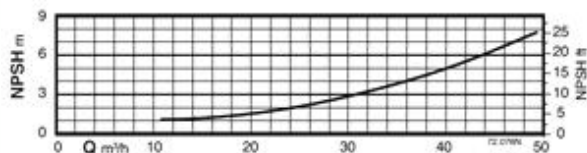
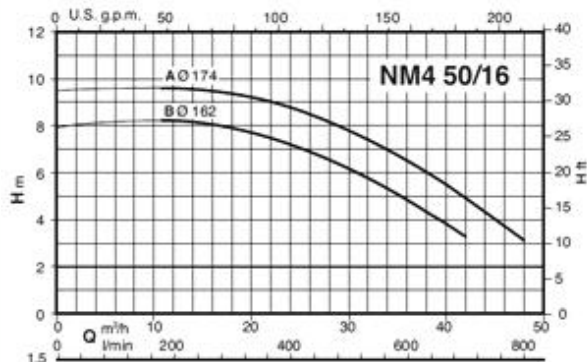

Massbild NM4 50

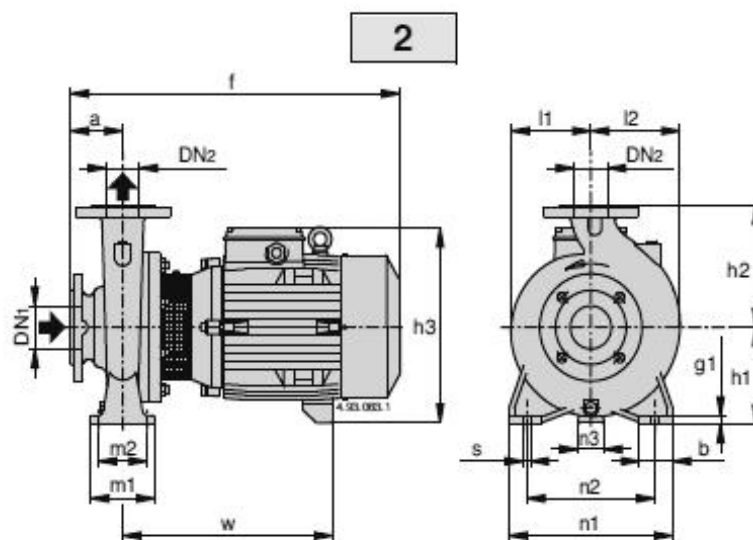

Pumpenmasse 4 - polig, 1450 ¹/min

Pumpentyp	Artikel-Nr.	Abmessungen in mm														Gewicht kg
		Bild	a	f	h1	h2	h3	m1	m2	n1	l1	l2	w	DN1	DN2	
NM4 50/16B/B	111.07730	2	100	470	160	180	288	100	70	265	127	141	295	65	50	39.5
NM4 50/16A/B	111.07731	2	100	470	160	180	288	100	70	265	127	141	295	65	50	40
NM4 50/20C/B	111.07732	2	100	480	160	200	288	100	70	265	140	153	305	65	50	44.5
NM4 50/20B/B	111.07733	2	100	505	160	200	288	100	70	265	140	153	310	65	50	52.5
NM4 50/20A/B	111.07734	2	100	505	160	200	288	100	70	265	140	153	310	65	50	57
NM4 50/25D/A	111.07735	2	100	490	180	225	308	125	95	320	175	175	300	65	50	68
NM4 50/25C/B	111.07736	2	100	490	180	225	308	125	95	320	175	175	300	65	50	68
NM4 50/25B/B	111.07737	2	100	530	180	225	340	125	95	320	175	175	330	65	50	77.5
NM4 50/25A/B	111.07738	2	100	530	180	225	340	125	95	320	175	175	330	65	50	85.5

Motordaten NM4 50, 4-polig, 1450 ¹/min

Pumpentyp	Leistung kW	Eingangsstrom in Ampere		
		3~230 V	3~400 V	3~690 V
NM4 50/16B/B	1.1	5	2.9	
NM4 50/16A/B	1.1	5	2.9	
NM4 50/20C/B	1.1	5	2.9	
NM4 50/20B/B	1.1	5	2.9	
NM4 50/20A/B	2.2	8.6	5	
NM4 50/25D/A	2.2	8.6	5	
NM4 50/25C/B	2.2	8.6	5	
NM4 50/25B/B	3	11.1	6.4	
NM4 50/25A/B	4		8.3	4.8



BRUNNER AG
 Brunnergässli 1
 CH-8302 Kloten
 Tel. 044 814 17 44
 Fax 044 814 17 75
 mail@brunnerpumpen.ch

BRUNNER AG
 Seefeldstrasse 1
 CH-8280 Kreuzlingen
 Tel. 079 654 01 48
 Fax 071 688 82 37
 www.brunnerpumpen.ch

BRUNNER SA
 Via in Paes 82
 CH-6572 Quartino
 Tel. 091 795 21 26
 Fax 091 795 28 92
 www.brunnerpompe.ch